

No. of DIME NSIONS		
Contacts	A	B
2	2.54	5.08
3	5.08	7.62
4	7.62	10.16
5	10.16	12.70
6	12.70	15.24
7	15.24	17.78
8	17.78	20.32
9	20.32	22.86
10	22.86	25.40
11	25.40	27.94
12	27.94	30.48
13	30.48	33.02
14	33.02	35.56
15	35.56	38.10
16	38.10	40.64
17	40.64	43.18
18	43.18	45.72
19	45.72	48.26
20	48.26	50.80
21	50.80	53.34
22	53.34	55.88
23	55.88	58.42
24	58.42	60.96
25	60.96	63.50
26	63.50	66.04
27	66.04	68.58
28	68.58	71.12
29	71.12	73.66
30	73.66	76.20
31	76.20	78.74
32	78.74	81.28
33	81.28	83.82
34	83.82	86.36
35	86.36	88.90
36	88.90	91.44
37	91.44	93.98
38	93.98	96.52
39	96.52	99.06
40	99.06	101.60

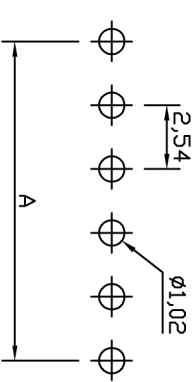
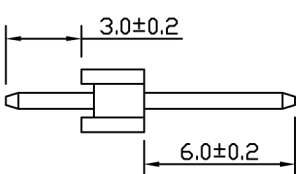
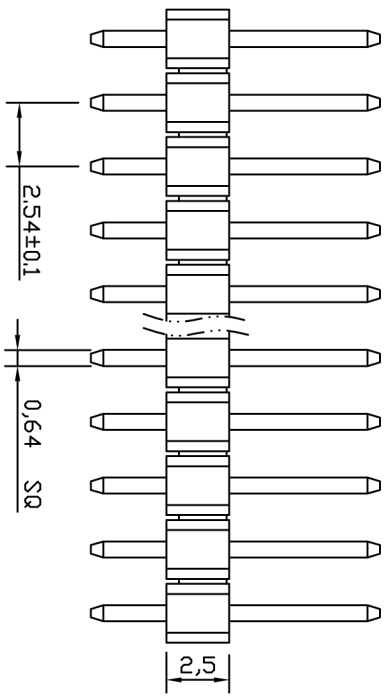
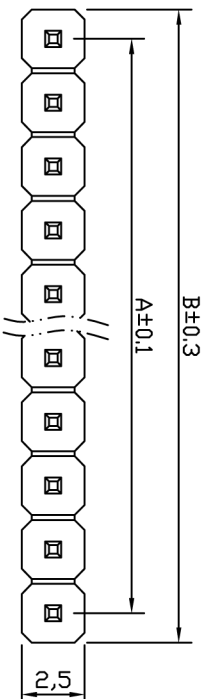

Recommended P.C.B Hole Layout

### SPECIFICATIONS

- Current Rating: 3Amps
- Insulation Resistance: 1000MΩ Min
- Contact Resistance: 20mΩ Max
- Withstanding Voltage: AC 1000V
- Operation Temperature: -40°to +105°
- Contact Material: Brass
- Insulator Material: Polyester(UL 94V-0)
- Standard: PBT

检验以此为准!

UNLESS OTHEWIXE		
SPECIFIED TOLERANCE		
ANG	±5°	
0	±0.3	
.00	±0.15	
	±0.05	

SCALE	UNIT	DRAWN NAME
mm		Pin header 2.54mm*2.5mm

DRAWN	CHECKED	PRODUCT NO.
李北林		

APPROVED	SIZE	REV	FILE NAME:
	A4	A	

2.54PH 1\*NPin H2.5 180° L11.5mm

JL-OK-723

1	2	3	4	5	6	7	8	9