

	1	2	3	4	5	6	7	8	9
	Contact	Dim A	Dim B	Dim C	Dim D				
G	4	5.08	2.54	7.62	10.16				
	6	7.62	5.08	7.62	10.16				
	8	10.16	7.62	7.62	10.16				
	10	12.70	10.16	7.62	10.16				
F	14	17.78	15.24	7.62	10.16				
	16	20.32	17.78	7.62	10.16				
	18	22.86	20.32	7.62	10.16				
	20	25.40	22.86	7.62	10.16				
E	24	30.48	27.94	7.62	10.16				
	28	35.56	33.02	7.62	10.16				
	16	20.32	17.78	10.16	12.70				
	20	25.40	22.86	10.16	12.70				
D	22	27.94	25.40	10.16	12.70				
	24	30.48	27.94	10.16	12.70				
	28	35.56	33.02	10.16	12.70				
	24	30.48	27.94	15.24	17.78				
C	28	35.56	33.02	15.24	17.78				
	32	40.64	38.10	15.24	17.78				
	36	45.72	43.18	15.24	17.78				
	40	50.80	48.26	15.24	17.78				
B	42	53.34	50.80	15.24	17.78				
	48	60.96	58.42	15.24	17.78				
	50	63.50	60.96	15.24	17.78				
	52	66.04	63.50	15.24	17.78				
A	50	63.50	60.96	22.86	25.40				
	52	66.04	63.50	22.86	25.40				
	64	81.28	78.74	22.86	25.40				

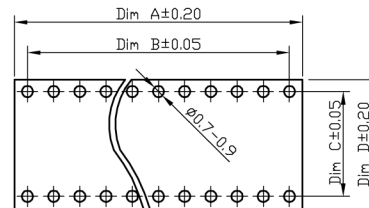
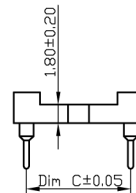
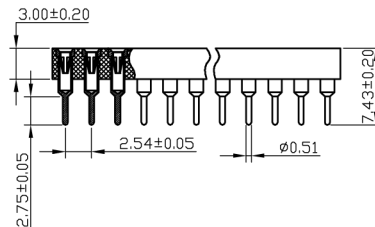
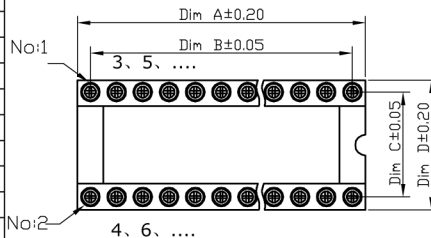

PCB LAYOUT

Technical Specs:

Insulator: Black glass filled polyester PBT-GF30-FR
 Flammability: UL 94V-O
 Sleeve: Brass
 Contact clip(4 finger): Beryllium copper(C17200)
 Accepted pin: Ø0.40 to 0.56mm
 Forces: (polished steel gauge Ø0.43mm)
 --Insertion 2 N typ
 --Withdrawal 1 N typ
 Mechanical life: min100 cycles
 Rated current: 1A
 Contact resistance: max 10mΩ
 Dielectric resistance: Min 1000V RMS

	1	2	3	4	5	6	7	8	9
	Plastics Height 30=3.0	Number of Pin 04 to 64Pins	Insulator Type Code 3: 7.62 4: 10.16 5: 15.24 6: 22.86	Pin Plating code 1: Tin 150u" 2: Tin 200u" 3: Gold Flash 4: 2U"Gold 5: 3U"Gold 6: 10U"Gold S: special	Clip Plating code 1: Tin 150u" 2: Tin 200u" 3: Gold Flash 4: 2U"Gold 5: 3U"Gold 6: 10U"Gold S: special	The Shape Of Pins S: 180° R: 90°	Insulator color A: Black B: White C: Blue		
	7210-30	XX	X	2	3	S	X		

JiLN 深圳市锦凌电子有限公司 SHENZHEN JINLING ELECTRONICS CO.,LTD Tel: 86-755-2997-5818 Fax: 86-755-2997-5588					
UNLESS OTHERWISE SPECIFIED TOLERANCE X : ±0.3 X° : ±5° X.X : ±0.2 X.X° : ±1° X.XX : ±0.1 X.XX° : ±0.5°			DRAWING NAME: 2.54x3.0圆孔IC座/L=7.43(方孔)		
SIZE	A4	SCALE	N:1	Drawing No.	IC254-30-0743-009
REV	A	UNIT	mm	PROJECT	
CRAW:	曾春明		CHECKED:	APPROVED:	
DATE:	12/04/11		DATE:	/ /	