

4611110008679

A

B

C

D

E

F

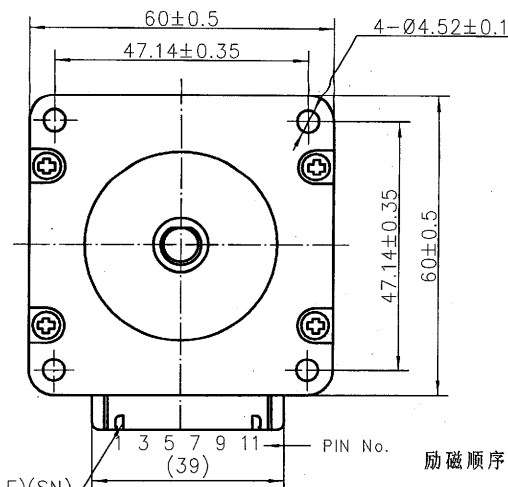
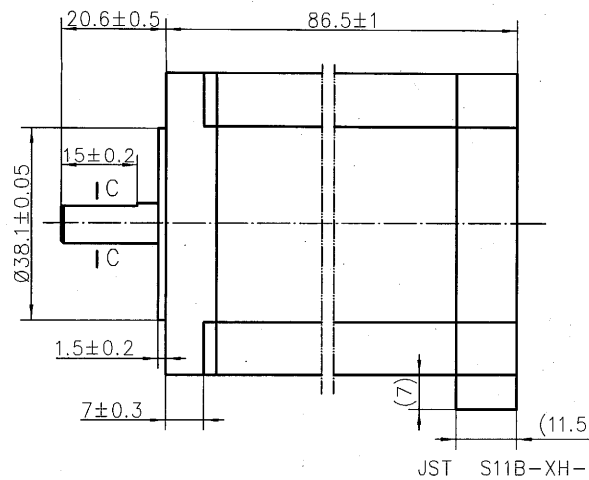
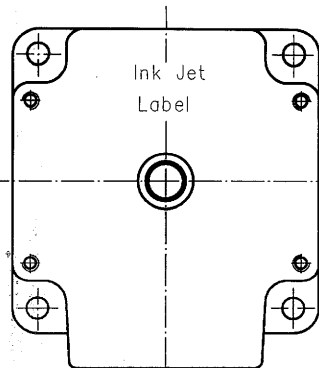

接线图

Wiring Diagram

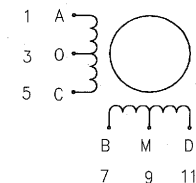

规格 Specifications

1. 相数 Number of Phase	4
2. 步距角 Step Angle	1.8°
3. 额定电压 Rated Voltage	10 V DC
4. 额定电流 Rated Current	1.0Amp
5. 保持力矩 Holding Torque	1.9N.m Min.(Two phase on/rated current)
6. 相电阻 Phase Resistance	10 ohm±10%(20°C)
7. 相电感 Phase Inductance	19.5 mH±20%(1kHz 1V rms)
8. 转子惯量 Rotor Inertia	900g.cm ²
9. 电机重量 Motor Weight	1.4kg
10. 绝缘等级 Insulation Class	B(130°C)

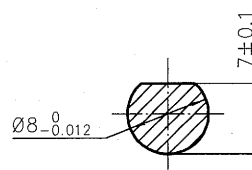
C-C
2:1

励磁顺序vs.旋转方向

Exciting Sequence vs. Direction of Rotation

STEP	A	B	C	D	O	M	CW
1	-	-			+	+	↑
2		-	-		+	+	
3			-	-	+	+	
4	-			-	+	+	

从安装面看为顺时针方向

Clockwise view from mounting side

铭牌 Label Detail

MOONS' STEPPING MOTOR
TYPE 24HS5004-02N
XXXXXXXX YY/MM/DD

Work Order Date Format
加工单号 日期格式

保密

Unit: mm

第一角画法
FIRST ANGLE METHOD未注线性与角度尺寸公差
Tolerances for linear and angular dimensions without
individual tolerance indications

GB/T 1804-m eqv ISO 2768-1: m

未注形状与位置尺寸公差
Geometrical tolerance for features without
individual tolerance indications

GB/T 1184-K eqv ISO 2768-2: K

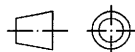

批准 Approve

标准化 Standard

工艺 Technology

审核 Check

设计 Design

7.0.0.0 4.13

2.0.0.0 4.13

2.0.0.0 4.13

2.0.0.0 4.13

张晓钢 2011.04.12

MOONS'

Hybrid Stepping Motor

Shanghai Moons' Electric Co., Ltd.

This document is released for information only. Its reproduction in whole or in part or its dissemination to third parties is prohibited. All trademarks and registered trademarks appearing on this document are the property of their respective owners.

REV.	版本记录 REVISION RECORD	DATE	UNLESS OTHERWISE SPECIFIED	NAMES	SIGNATURE	DATE	Type: 24HS5004-02N	Rev.A	SCALE 1:1	Sheet 1 of 1
------	----------------------	------	----------------------------	-------	-----------	------	--------------------	-------	-----------	--------------

1

2

3

4

5

6

7

8